

Designed for systems that require pressure regulation at an inaccessible location.

A pilot regulator (ordered separately) controls the outlet pressure of the pilot operated regulator.



### Technical data

#### Fluid:

Compressed air, neutral gases  
NOTE: Contact technical support for use with other media.

#### Inlet pressure range:

10 psig (0.7 bar) to 300 psig (20 bar)

#### Operating temperature:

0° to 175°F (-20° to 80°C)\*\*  
\*\* Air supply must be dry enough to avoid ice formation at temperatures below 35°F (2°C).

#### Materials

Body, top cap: zinc  
main valve, adjusting screw: brass  
pilot valve, relief valve: acetal  
Elastomers: nitrile  
Bottom plug: acetal

#### Port sizes

Main	Gauge	Pilot
1/4"	1/4"	1/4"
3/8"	3/8"	1/4"
1/2", 3/4", 1", 1-1/4"	1/2"	1/4"

### Ordering information

Models listed include relieving diaphragm and PTF threads. Requires a pilot regulator (ordered separately).

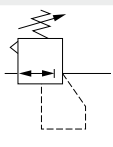
ISO Symbols	Port Size	Model	Flow† scfm (dm <sup>3</sup> /s)	Weight lb (kg)
 R24 Relieving	1/4"	R24-201-RNXA		1.16 (0.73)
	3/8"	R24-301-RNXA		1.54 (0.70)
	1/2"	R24-401-RNXA	220*	1.50 (0.68)
	3/4"	R24-601-RNXA		2.60 (1.18)
	1"	R24-801-RNXA		2.60 (1.18)
	1-1/4"	R24-A01-RNXA††	700*	2.51 (1.14)

\* Typical flow with 150 psig (10 bar) inlet pressure, 90 psig (6.3 bar) set pressure and 15 psig (1 bar) droop from set.

### Alternative Models

Port Size	Substitute	<b>R24-★01-RNX★</b>		Threads	Substitute
1/4"	2			PTF	A
3/8"	3			ISO G parallel	G
1/2"	4				
3/4"	6				
1"	8				
1-1/4"	A				

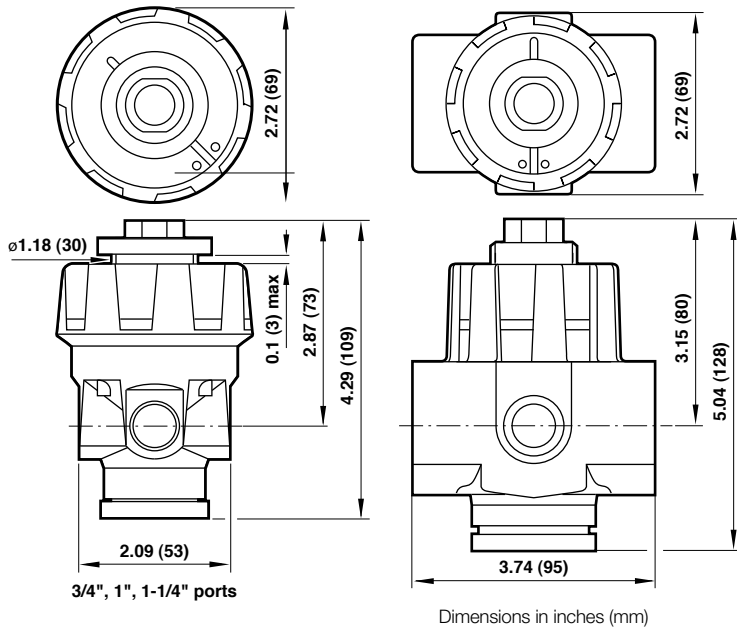

**Service Kits**

Item	Port size	Part number
Service kit	1/4", 3/8", 1/2"	5292-54
Service kit	3/4", 1", 1-1/4"	5292-55

Service kits include seals, main valve and spring.

**Typical Performance Characteristics**

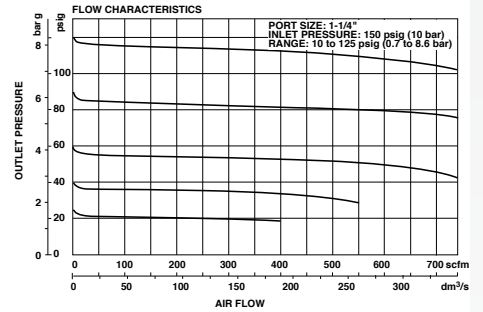
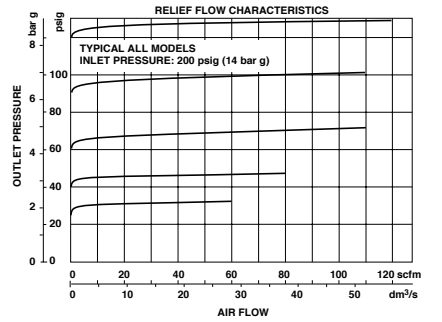
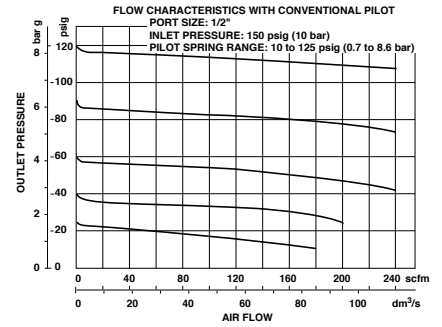

**Typical Installation**

Feedback Pilot and Pilot Operated Regulator

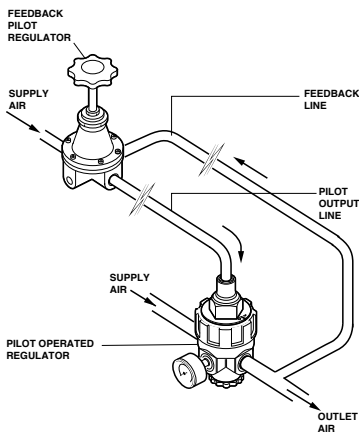

**Typical Installation**

Conventional Pilot and Pilot Operated Regulator

